

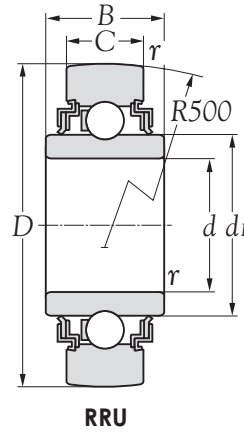

**DIMENSION TABLES**

**TRACK ROLLER BEARINGS DOUBLE ROW**  
**SERIES LR..NPP; LR..RRU**

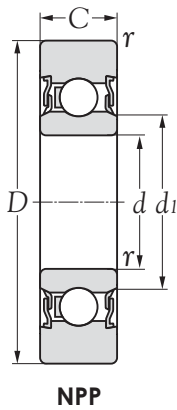

Boundary dimensions						Basic load ratings		Limiting speeds		Bearing number	Mass
mm						dynamic	static	rpm			
<i>d</i>	<i>D</i>	<i>C</i>	<i>r<sub>s</sub></i>	<i>d<sub>1</sub></i>	<i>B</i>	<i>C</i>	<i>C<sub>0</sub></i>	grease	oil		(approx.)
10	32	9	0.6	15.4	-	4,200	2,050	13,000	-	<b>LR 200 NPP</b>	0.050
12	35	10	0.6	17.1	-	5,500	2,600	15,000	-	<b>LR 201 NPP</b>	0.050
15	40	11	0.6	20.0	-	6,700	3,150	14,000	-	<b>LR 202 NPP</b>	0.070
17	47	12	0.6	22.5	-	9,100	4,200	11,000	-	<b>LR 203 NPP</b>	0.110
20	52	14	1.0	26.5	-	11,800	5,400	10,000	-	<b>LR 204 NPP</b>	0.150
25	62	15	1.0	30.3	-	14,900	6,800	9,000	-	<b>LR 205 NPP</b>	0.230
30	72	16	1.0	37.4	-	20,800	9,200	5,500	-	<b>LR 206 NPP</b>	0.330
35	80	17	1.1	42.4	-	26,100	11,400	4,500	-	<b>LR 207 NPP</b>	0.400
45	90	19	1.1	53.2	-	30,300	13,100	3,600	-	<b>LR 209 NPP</b>	0.450
12	35	10	0.6	18.5	15.0	5,500	3,000	15,000	-	<b>LR 201 RRU</b>	0.070
15	40	11	0.6	21.5	14.4	6,700	3,500	14,000	-	<b>LR 202 RRU</b>	0.080

**TRACK ROLLER BEARINGS DOUBLE ROW**  
**SERIES LR 52..NPPU; LR 52..KDD**

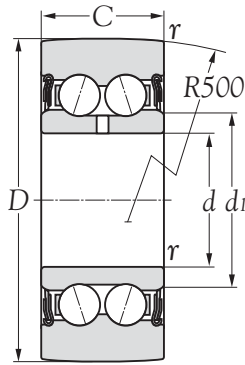

**NPPU**

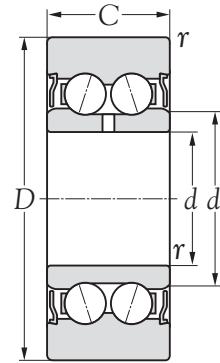

**KDD**

Boundary dimensions					Basic load ratings		Limiting speeds		Bearing number	Mass
mm					dynamic	static	rpm			
<i>d</i>	<i>D</i>	<i>C</i>	<i>r<sub>s</sub></i>	<i>d<sub>1</sub></i>	<i>C</i>	<i>C<sub>0</sub></i>	grease	oil		(approx.)
10	32	14.0	0.6	15.4	6,500	3,900	8,000	-	<b>LR 5200 NPPU</b>	0.070
12	35	15.9	0.6	17.1	8,500	4,900	7,500	-	<b>LR 5201 NPPU</b>	0.080
15	40	15.9	0.6	20.0	10,100	5,900	7,000	-	<b>LR 5202 NPPU</b>	0.110
17	47	17.5	0.6	22.5	13,700	7,800	5,500	-	<b>LR 5203 NPPU</b>	0.170
20	52	20.6	1.0	26.5	17,700	10,000	5,000	-	<b>LR 5204 NPPU</b>	0.230
25	62	20.6	1.0	30.3	22,000	12,400	4,500	-	<b>LR 5205 NPPU</b>	0.340
30	72	23.8	1.0	37.4	30,700	20,400	3,500	-	<b>LR 5206 NPPU</b>	0.510
35	80	27.0	1.1	42.4	39,400	21,300	2,800	-	<b>LR 5207 NPPU</b>	0.660
40	85	30.2	1.1	48.4	45,500	24,300	2,500	-	<b>LR 5208 NPPU</b>	0.750
10	32	14.0	0.6	15.4	6,500	3,900	11,000	-	<b>LR 5200 KDD</b>	0.070
12	35	15.9	0.6	17.1	8,500	4,900	10,000	-	<b>LR 5201 KDD</b>	0.080
15	40	15.9	0.6	20.0	10,100	5,900	10,000	-	<b>LR 5202 KDD</b>	0.110
17	47	17.5	0.6	22.5	13,700	7,800	7,500	-	<b>LR 5203 KDD</b>	0.170
20	52	20.6	1.0	26.5	17,700	10,000	7,000	-	<b>LR 5204 KDD</b>	0.230
25	62	20.6	1.0	30.3	22,000	12,400	6,500	-	<b>LR 5205 KDD</b>	0.340
30	72	23.8	1.0	37.4	30,700	20,400	5,000	-	<b>LR 5206 KDD</b>	0.510
35	80	27.0	1.1	42.4	39,400	21,300	3,900	-	<b>LR 5207 KDD</b>	0.660
40	85	30.2	1.1	48.4	45,500	24,300	3,500	-	<b>LR 5208 KDD</b>	0.750

**TRACK ROLLER BEARINGS DOUBLE ROW**  
**SERIES LR 53.. NPPU**

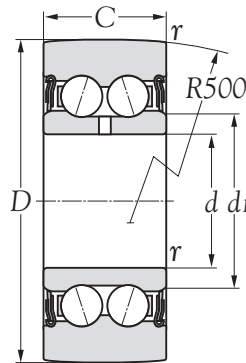

Boundary dimensions					Basic load ratings		Limiting speeds		Bearing number	Mass
mm					dynamic	static	rpm			
<i>d</i>	<i>D</i>	<i>C</i>	<i>r<sub>s</sub></i>	<i>d<sub>1</sub></i>	<i>C</i>	<i>C<sub>0</sub></i>	grease	oil		(approx.)
17	52	22.2	1.0	23.5	19,300	10,600	4,700	-	<b>LR 5303 NPPU</b>	0.210
20	62	22.2	1.1	29.0	25,100	13,800	4,500	-	<b>LR 5304 NPPU</b>	0.340
25	72	25.4	1.1	34.4	34,300	18,600	3,900	-	<b>LR 5305 NPPU</b>	0.500
30	80	30.2	1.1	41.4	47,200	25,200	3,100	-	<b>LR 5306 NPPU</b>	0.670
35	90	34.9	1.5	47.7	59,800	31,400	2,500	-	<b>LR 5307 NPPU</b>	0.970
40	100	36.5	1.5	52.4	78,000	39,900	2,300	-	<b>LR 5308 NPPU</b>	1.200

**TRACK ROLLER BEARINGS DOUBLE ROW**  
**SERIES LFR..2RS; LFR..2Z**

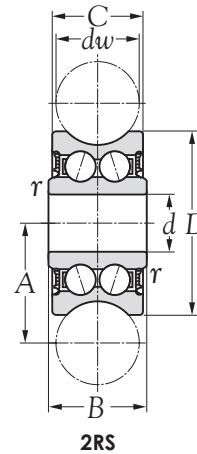
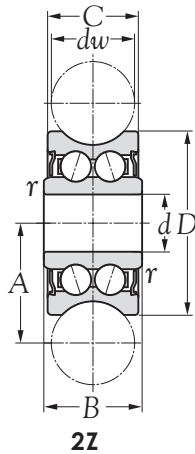

Boundary dimensions							Basic load ratings		Limiting speeds		Bearing number		Mass
mm							dynamic	static	rpm				kg
<i>d</i>	<i>d<sub>w</sub></i>	<i>D</i>	<i>C</i>	<i>B</i>	<i>A</i>	<i>r<sub>s</sub></i>	<i>C</i>	<i>C<sub>0</sub></i>	grease	oil			(approx.)
4	4	13.0	6.0	7.0	7.55	0.2	1,050	850	1,150	1,600	<b>LFR 50/4-4 2Z</b>	<b>LFR 50/4-4 2RS</b>	0.007
5	4	16.0	7.0	8.0	9.00	0.2	1,200	860	1,300	1,780	<b>LFR 50/5-4 2Z</b>	<b>LFR 50/5-4 2RS</b>	0.009
5	6	17.0	7.0	8.0	10.50	0.2	1,270	820	1,300	1,780	<b>LFR 50/5-6 2Z</b>	<b>LFR 50/5-6 2RS</b>	0.010
8	6	24.0	11.0	11.0	14.00	0.3	3,670	2,280	1,300	4,560	<b>LFR 50/8-6 2Z</b>	<b>LFR 50/8-6 2RS</b>	0.020
12	10	35.0	15.9	15.9	20.65	0.3	8,500	5,100	5,100	10,200	<b>LFR 5201-10 2Z</b>	<b>LFR 5201-10 2RS</b>	0.080
12	10	42.0	19.0	19.0	24.00	0.6	13,000	7,700	7,500	14,200	<b>LFR 5301-10 2Z</b>	<b>LFR 5301-10 2RS</b>	0.100
15	10	47.0	19.0	19.0	26.65	1.0	16,200	9,200	6,200	18,400	<b>LFLFR 5302-10 2Z</b>	<b>LFR 5302-10 2RS</b>	0.170
12	12	35.0	15.9	15.9	21.75	0.3	8,400	5,000	5,100	10,000	<b>LFR 5201-12 2Z</b>	<b>LFR 5201-12 2RS</b>	0.085
12	14	39.9	18.0	20.0	24.00	0.3	8,900	5,000	6,700	12,100	<b>LFR 5201-14 2Z</b>	<b>LFR 5201-14 2RS</b>	0.095
20	16	52.0	20.6	22.6	31.50	0.6	16,800	9,500	12,100	16,600	<b>LFR 5204-16 2Z*</b>	<b>LFR 5204-16 2RS*</b>	0.230
25	20	72.0	23.8	25.8	41.00	0.6	29,500	16,600	20,700	33,200	<b>LFR 5206-20 2Z*</b>	<b>LFR 5206-20 2RS*</b>	0.250
25	25	72.0	23.8	25.8	43.50	0.6	29,200	16,400	23,100	32,800	<b>LFR 5206-25 2Z*</b>	<b>LFR 5206-25 2RS*</b>	0.250
30	30	80.0	27.0	29.0	51.00	1.0	38,000	20,800	21,400	36,200	<b>LFR 5207-30 2Z*</b>	<b>LFR 5207-30 2RS*</b>	0.660
40	40	98.0	36.0	38.0	62.50	1.0	54,800	29,000	55,000	58,000	<b>LFR 5208-40 2Z*</b>	<b>LFR 5208-40 2RS*</b>	1.360
40	50	110.0	44.0	46.0	72.50	1.1	53,000	39,500	69,000	79,000	<b>LFR 5308-50 2Z*</b>	<b>LFR 5308-50 2RS*</b>	1.400

Remark: \* Standard with lubrication hole on inner ring

**TRACK ROLLER BEARINGS DOUBLE ROW**

**SERIES RC..; RE..**

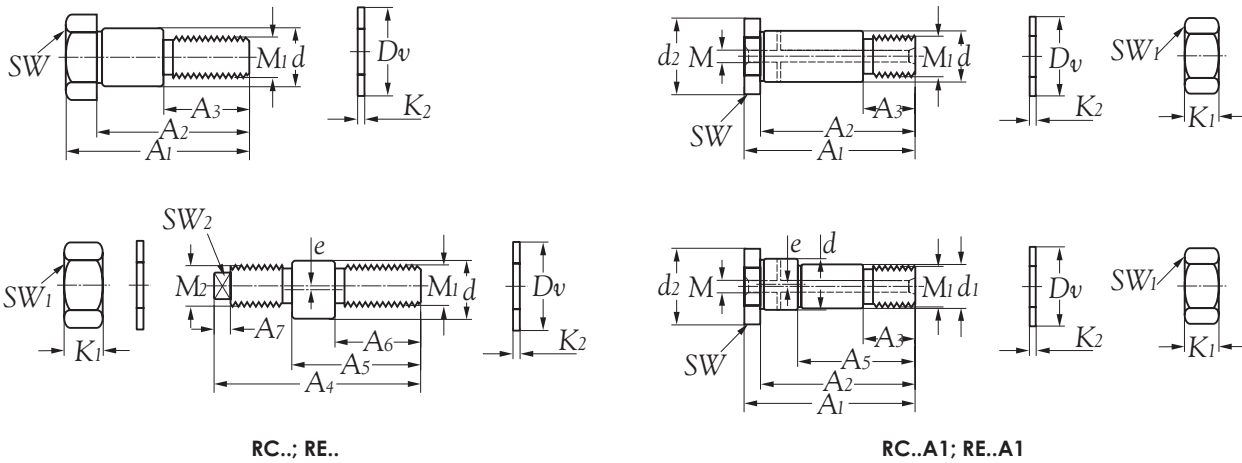

**RC..; RE..**

**RC..A1; RE..A1**

Boundary dimensions																			Bearing number	Mass kg (approx.)
$A_1$	$A_2$	$A_3$	$A_4$	$A_5$	$A_6$	$A_7$ $h_9$	$d_1$	$d_2$	mm $M_1$	$M_2$	$K_1$	$K_2$	$D_v$	SW	$SW_1$	$SW_2$	$e$	$M$		
19.5	16.0	9.5	20.5	15.0	9.0	-	-	-	M4	M4	2.9	-	-	3	7	2	0.50	-	<b>RC 5; RE 5-05</b>	0.010
28.3	24.3	14.0	33.2	22.0	13.7	3.5	-	-	M8	M8x0.75	4.0	1.0	14	13	13	2	1.00	-	<b>RC 8; RE 8-1</b>	0.020
43.0	36.0	22.0	50.0	33.5	19.5	5.0	-	-	M10	M10	8.0	1.8	21	17	17	5	1.00	-	<b>RC 12; RE 12-1</b>	0.040
50.8	43.8	24.0	57.0	41.0	24.0	5.0	-	-	M12	M12	6.5	1.8	19	17	17	6	1.00	-	<b>RC 12/M12; RE 12-1/M12</b>	0.060
50.8	43.8	26.0	57.0	41.0	24.0	5.0	-	-	M12	M12	6.5	1.8	21	19	19	6	1.00	-	<b>RC 15; RE 15-1</b>	0.060
50.0	45.0	16.0	-	30.0	-	-	10	20	M10x1.5	-	8.0	2.0	21	17	17	6	0.75	5.9	<b>RC 12X45 A1; RE 12X45 A1</b>	0.040
75.0	67.0	23.0	-	45.0	-	-	17	30	M16x1.5	-	13.0	3.0	30	27	24	-	1.00	5.9	<b>RC 20X67 A1; RE 20X67 A1</b>	0.200
92.0	82.0	30.0	-	57.0	-	-	22	40	M20x1.5	-	16.0	3.0	37	36	30	-	1.00	5.9	<b>RC 25X82 A1; RE 25X82 A1</b>	0.400
107.0	95.0	32.0	-	67.0	-	-	27	45	M24x1.5	-	19.0	4.0	44	41	36	-	1.00	5.9	<b>RC 30X95 A1; RE 30X95 A1</b>	0.620
117.0	107.0	42.0	-	72.0	-	-	36	55	M30x1.5	-	24.0	4.0	56	46	46	-	1.00	5.9	<b>RC 40X107 A1; RE 40X107 A1</b>	1.100
125.0	115.0	42.0	-	72.0	-	-	36	55	M30x1.5	-	24.0	4.0	56	46	46	-	1.00	5.9	<b>RC 40X115 A1; RE 40X115 A1</b>	1.200

**TRACK ROLLER BEARINGS DOUBLE ROW**  
**SERIES RV**

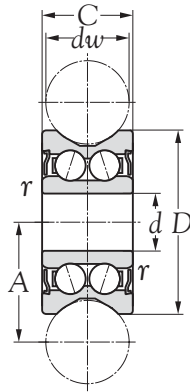

Boundary dimensions						Basic load ratings		Limiting speeds		Bearing number	Mass
mm						dynamic	static	rpm			
<i>d</i>	<i>d<sub>w</sub></i>	<i>D</i>	<i>C</i>	<i>A</i>	<i>r<sub>s</sub></i>	<i>C</i>	<i>C<sub>0</sub></i>	grease	oil		(approx.)
7	10	22	11	14.50	0.3	2,450	1,620	2,350	4,150	<b>RV 20/7-10</b>	0.017
8	10	30	14	18.10	0.3	4,490	2,700	11,000	19,800	<b>RV 20/8-10</b>	0.062
15	10	38	17	22.25	0.5	7,290	4,550	10,200	17,900	<b>RV 202/15.38-10</b>	0.086
15	10	40	18	22.00	0.5	7,950	4,950	14,500	26,500	<b>RV 20/15.40-10</b>	0.110
12	20	41	20	28.00	0.3	8,180	5,100	17,200	31,500	<b>RV 201/12-20</b>	0.130
15	20	41	20	28.00	0.5	8,180	5,100	17,200	31,500	<b>RV 202/15.41-20</b>	0.120
17	20	58	25	35.00	0.5	16,580	9,200	47,000	86,000	<b>RV 203/17-20</b>	0.325
20	30	57	22	41.00	0.6	16,910	9,200	47,000	86,000	<b>RV 204/20.57-30</b>	0.290
20	30	58	25	41.00	0.6	16,790	9,200	40,000	72,000	<b>RV 204/20.58-30</b>	0.310

Remark: \* The unit contamination protection is provided by side shields 2Z.

**TRACK ROLLER BEARINGS DOUBLE ROW**  
**SERIES RM..2Z; RM..2RS**

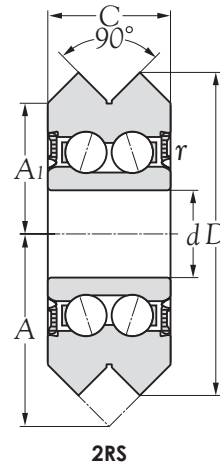
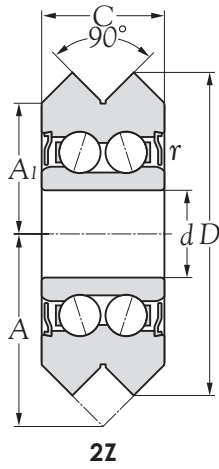

Boundary dimensions						Basic load ratings		Limiting speeds		Bearing number		Mass
mm						dynamic	static	rpm				kg
<i>d</i>	<i>D</i>	<i>A</i>	<i>C</i>	<i>A<sub>l</sub></i>	<i>r<sub>s</sub></i>	<i>C</i>	<i>C<sub>o</sub></i>	grease	oil			(approx.)
4.763	19.56	11.86	7.87	7.93	0.3	1,650	1,140	4,150	7,500	<b>RM 1 2Z</b>	<b>RM 1 2RS</b>	0.012
9.525	30.73	18.24	11.10	12.70	0.3	8,260	2,650	6,500	11,700	<b>RM 2 2Z</b>	<b>RM 2 2RS</b>	0.040
11.999	45.72	26.98	15.88	19.05	0.6	5,530	5,200	31,000	55,000	<b>RM 3 2Z</b>	<b>RM 3 2RS</b>	0.136
15.001	59.94	34.93	19.05	25.40	1.0	16,250	9,200	39,500	72,000	<b>RM 4 2Z</b>	<b>RM 4 2RS</b>	0.285



**TRACK ROLLER BEARINGS DOUBLE ROW**  
**SERIES RV..C; RV..E**

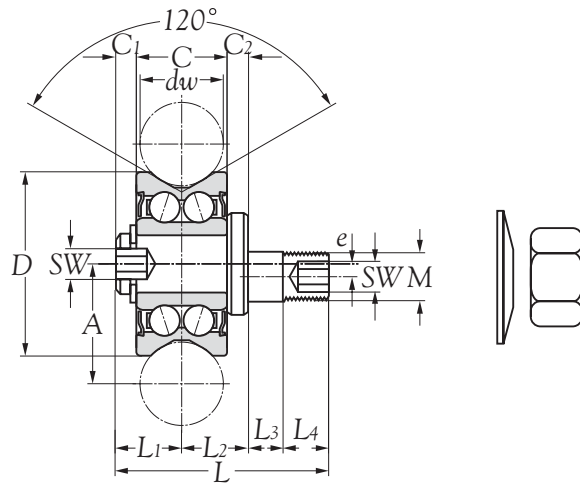

Boundary dimensions														Basic load ratings		Limiting speeds		Bearing number		Mass
mm														dynamic	static	rpm		concentric	eccentric	kg
$d_w$	$D$	$C$	$A$	$L$	$L_1$	$L_2$	$L_3$	$L_4$	$C_1$	$C_2$	$e$	$SW$	$M$	$C$	$C_0$	grease	oil			(approx.)
10	22	11	14.5	26	8.5	8	4	5.5	3	3.0	1.5	3	M 6	2,450	1,620	2,350	4,150	<b>RV 22 C</b>	<b>RV 22 E</b>	0.028
10	30	14	18.1	33	9.5	9	6	8.0	2	2.5	1.5	4	M 8	4,490	2,700	11,000	19,800	<b>RV 30 C</b>	<b>RV 30 E</b>	0.069
10	38	17	22.3	42	11.0	11	8	12.0	3	2.5	2.0	5	M 10	7,290	4,550	10,200	17,900	<b>RV 38 C</b>	<b>RV 38 E</b>	0.145
20	41	20	28.0	47	15.0	13	6	13.0	3	5.0	2.0	6	M 12	8,180	5,100	17,200	31,500	<b>RV 41 C</b>	<b>RV 41 E</b>	0.190
20	58	25	35.0	59	17.0	19	11	13.0	6	4.0	2.5	6	M 16	16,580	9,200	47,000	86,000	<b>RV 58 C</b>	<b>RV 58 E</b>	0.460

Remark: \* Track rollers with integral studs are supplied with split washer and nut.  
 \* The unit contamination protection is provided by side shields 2Z.

**TRACKROLLERBEARINGS DOUBLEROW**  
**SERIES RPC; RPE**

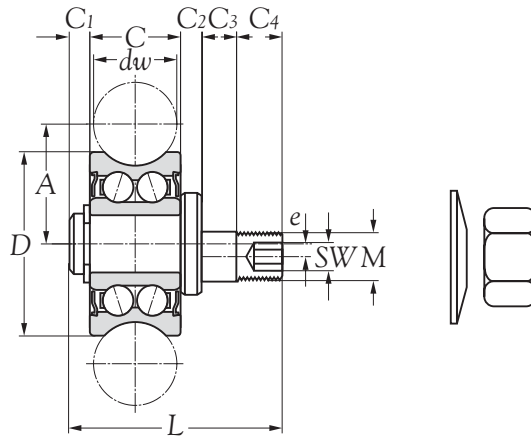

Boundary dimensions												Basic load ratings		Limiting speeds		Bearing number		Mass kg
mm												dynamic	static	rpm		concentric	eccentric	
$d_w$	$D$	$C$	$A$	$L$	$C_1$	$C_2$	$C_3$	$C_4$	$e$	SW	M	C	$C_0$	grease	oil			
6	17	7.0	10.50	23	1.5	1.5	5	5.5	0.50	2.5	M5	1,250	850	1,250	1,700	<b>RPC 17</b>	<b>RPE 17</b>	0.015
6	24	11.0	14.00	29	3.0	2.0	6	7.0	0.50	4.0	M8	3,500	2,200	1,250	4,350	<b>RPC 24</b>	<b>RPE 24</b>	0.042
10	35	15.9	20.65	44	3.2	2.0	10	13.0	0.75	5.0	M10	8,100	8,100	4,900	9,700	<b>RPC 35</b>	<b>RPE 35</b>	0.120

Remark: \* Track rollers with integral studs are supplied with split washer and nut.

**TRACK ROLLER BEARINGS DOUBLE ROW**  
**SERIES RA..A**

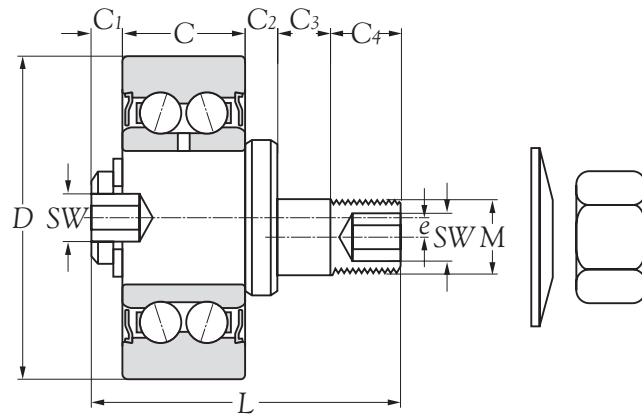

Boundary dimensions										Basic load ratings		Limiting speeds		Bearing number	Mass
mm										dynamic	static	rpm			
D	C	L	C <sub>1</sub>	C <sub>2</sub>	C <sub>3</sub>	C <sub>4</sub>	e	SW	M	C	C <sub>0</sub>	grease	oil		
35	15.9	42	2.1	5	6.0	13	1.0	5	M 12	8,100	4,900	4,900	9,700	<b>RA 35 A</b>	0.150
52	22.2	57	3.3	8	9.5	14	1.5	6	M 16	16,000	9,100	11,500	15,800	<b>RA 52 A</b>	0.345

Remark: \* Track rollers with integral studs are supplied with split washer and nut.  
 \* The unit contamination protection is provided by side shields 2Z.

**NIKO**<sup>®</sup>

**NIPPON KODO**  
AUTOMATION TECHNOLOGY

**NIPPON KODO CO., LTD.**  
**OSAKA-JAPAN**

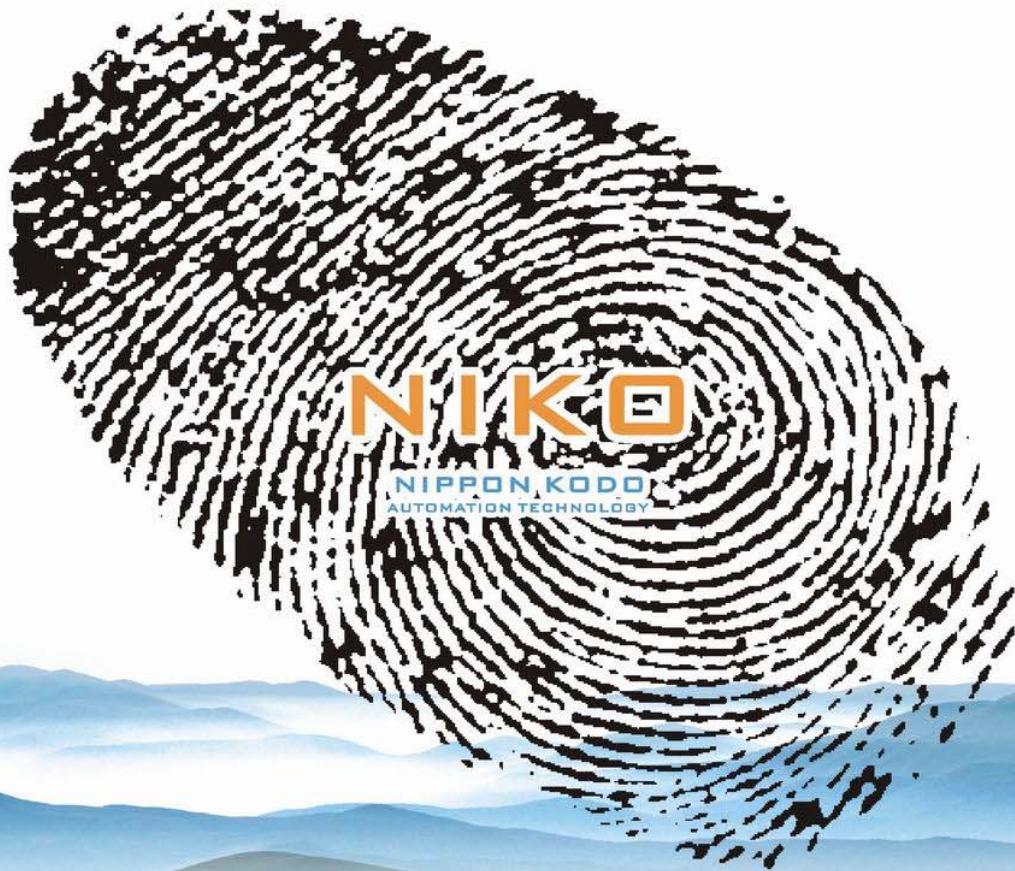

**Brand Promise!**